

## **DESIGN ON A DIME CHAPTER CONTENTS**

1. Design on a Dime Overview
2. What are the Key Elements of Good Budget Design?
3. Tips for Getting the Most Out of Your Decorating Budget
4. Determining Your Budget (And How to Stick With It!)
5. Defining Your Style: How to determine what styles you love, so you Save Time & Money
6. Developing a Color Palette for Your Home to Achieve the “Designer Look”
7. Selecting a Focal Point: Secrets of the Pros
8. The Basics of Room Arrangement Explained
9. Working with What You Already Have (yes, it is possible!)
10. Furniture Proportion and Scale – Costly Mistakes You Can Avoid
11. Selecting and Coordinating Fabrics for Maximum Impact
12. Window Coverings Don’t Have to Cost a Fortune
13. Decorating with Framed Artwork and Pictures: Tips for a Unified Look
14. Lighting for Drama & Function (and most overlooked!)
15. What to Splurge on and What to Save on for the Biggest Impact
16. Do’s and Don’ts of Spending Your Budget Wisely
17. Tips on Accessorizing to Create Interest
18. Design On a Dime Resources to Help You Shop Smartly & Efficiently

---

## **SAMPLE PAGES – EXCERPT FROM CHAPTER 8**

### **THE BASICS OF ROOM ARRANGEMENT**

**Take Traffic Patterns into Consideration:** You can direct the flow of traffic through a room with the placement of your furniture. You must consider doors, windows, fireplaces and heating/cooling units when finding the natural flow. Leave a minimum of two and a half feet (36" is ideal) for walkways and avoid flowing traffic through a conversation grouping if possible. Guide the traffic around the room's perimeter to create a less disruptive environment.

Do not arrange furniture too far away from a focal point (refer to previous chapter to determine focal point), particularly a television or fireplace. Nor should you put all the furniture against a wall or on one side of a room. For a good conversation area, make sure the furniture is arranged so people will not be more than 10 feet apart.

At the same time, do not put furniture pieces so close together that traffic is blocked in the room or at entrances and exits (see diagram below). In arranging the furniture, avoid the mistake of placing everything against the wall. Be bold. Set sofas or area rugs on angles--it is more visually interesting.

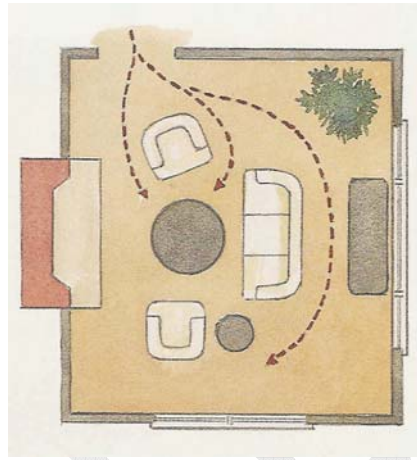
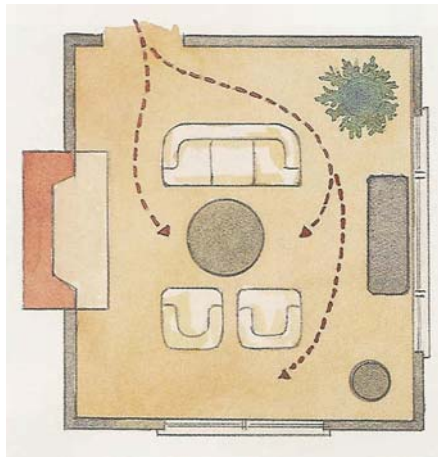

These three Traffic patterns show the various ways you can arrange the same furnishings and keep the traffic flow open. Functionality is usually the deciding factor.

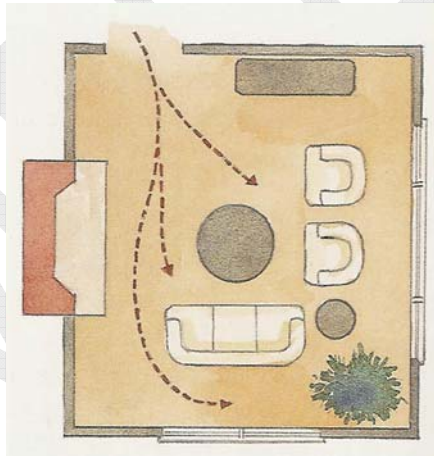

**Form Follows Function:** The design statement “Form Follows Function,” is very true, so your room must properly function first and foremost. When you have properly arranged the room, the space will feel balanced and comfortable.